

SITE SPECIFIC HAZARDS

IN ACCORDANCE WITH THE REQUIREMENTS OF THE CDM REGULATIONS 2015 THE FOLLOWING SIGNIFICANT RESIDUAL HAZARDS HAVE NOT BEEN DESIGNED OUT OF THIS PROJECT AND MUST BE TAKEN INTO CONSIDERATION BY CONTRACTORS PLANNING TO UNDERTAKE THE WORKS SHOWN ON THIS DRAWING:

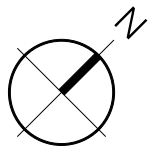

NOTES

DRAWING PRODUCED BASED ON AS BUILT RECORD INFORMATION PREPARED BY MECHANICAL ENGINEERS; ALL DIMENSIONS TO BE CHECKED ON SITE

DRAWING TO BE READ IN CONJUNCTION WITH RELEVANT FIRE STRATEGY DRAWINGS

CONDITION OF EXISTING DOORS TO BE REVIEWED ON SITE AND REFURBISHED WHERE REQUIRED SUBJECT TO AGREEMENT WITH CLIENT

ANY EXISTING FIRE RATED DOORS TO BE REVIEWED AND REPAIRED WHERE NECESSARY TO ENSURE THE FIRE RATING OF DOORS IS MAINTAINED.

HEIGHT OF SUSPENDED CEILING AND SOFFIT ABOVE SUBJECT TO CHECK ON SITE

ENCASEMENT NOTE: EXISTING PLASTERBOARD COLUMN ENCASEMENTS TO BE REVIEWED ON SITE; CONTRACTOR TO MAKE ALLOWANCES FOR MODIFICATION WORKS TO ENSURE CONTINUITY OF FIRE PROTECTION

FOR PARTITION SETTING OUT REFER TO RGP DRAWING 11665-C-P12

LEGEND

- DENOTES PROPOSED PARTITION
- COLUMNS AND ENCASEMENTS TO BE RETAINED SUBJECT TO FURTHER REVIEW ON SITE (see notes)
- DOOR REFERENCE; REFER TO RGP INTERNAL DOOR SCHEDULE; REF 11665.13.01
- NEWLY FORMED CORRIDOR
- RECONFIGURED OFFICE ACCOMMODATION

H	19/03/25	CONSTRUCTION ISSUE: MINOR UPDATES; DIMENSIONS ADDED	JH
G	04/02/25	REVERTED TO PREVIOUS LAYOUT FOLLOWING CLIENT COMMENTS; FULL DIVISION OF SUITE 4 INTO TWO SEPERATE SUITES 4 & 5	WDD
F	22/01/25	RELOCATION OF COMMS ROOMS TO LEFT SIDE OF KITCHEN; ADDITION OF SLIDING DOOR IN SUITE 4 & 5 PARTITION, RELOCATION OF 3D08	WDD
E	17/01/25	REVERTED TO EXISTING KITCHEN LAYOUT; SUITE 4 & 5 CONJOINED; ADDITION OF 2x3.2M CLEAR DOORS IN SUITE 4 PARTITION	WDD
D	17/09/24	REVERTED TO PREVIOUS LAYOUT FOLLOWING CLIENT COMMENTS IN REGARDS TO TENANTS	RG
C	19/08/24	NOTES REGARDING GLAZED PARTITION ADDED FOLLOWING FEEDBACK FROM BUILDING CONTROL; LEGEND UPDATED; MINOR AMENMENTS TO WALL SPEC NOTE	JH
B	18/07/24	LOBBIES OMITTED; NOTES AND KEY UPDATED	JH
A	16/07/24	UPDATED TO REFLECT COMMENTS FROM CLIENT.	DB
REV.	DATE	NOTES	INIT.

CLIENT / PROJECT

HURSTWOOD HOLDINGS
AQUEOUS II, BIRMINGHAM

DRAWING TITLE

PROPOSED THIRD FLOOR PLAN
PROPOSED SUBDIVISION

STATUS		CONSTRUCTION	
DATE	DRAWN	SCALE @ A2	
JULY '24	RG	1:100	
PROJECT NUMBER	UNIT / BLOCK	CI / SFB CODE	TYPE & NUMBER
11665	C	P06	H
Site Location Plans	L	GA Plans	P
Sections	S	Details	D
		Elevations	E
		Prefix: Colour	C

THE RATCLIFFE GROVES PARTNERSHIP

MANCHESTER
105 MANCHESTER ROAD
BURY LANCASHIRE BL9 0TD
T. 0161 797 6000 E. manchester@rgp.uk.com
www.rgp.uk.com

LONDON
19 BEDFORD ROW
LONDON WC1R 4EB
T. 020 7600 6666 E. london@rgp.uk.com

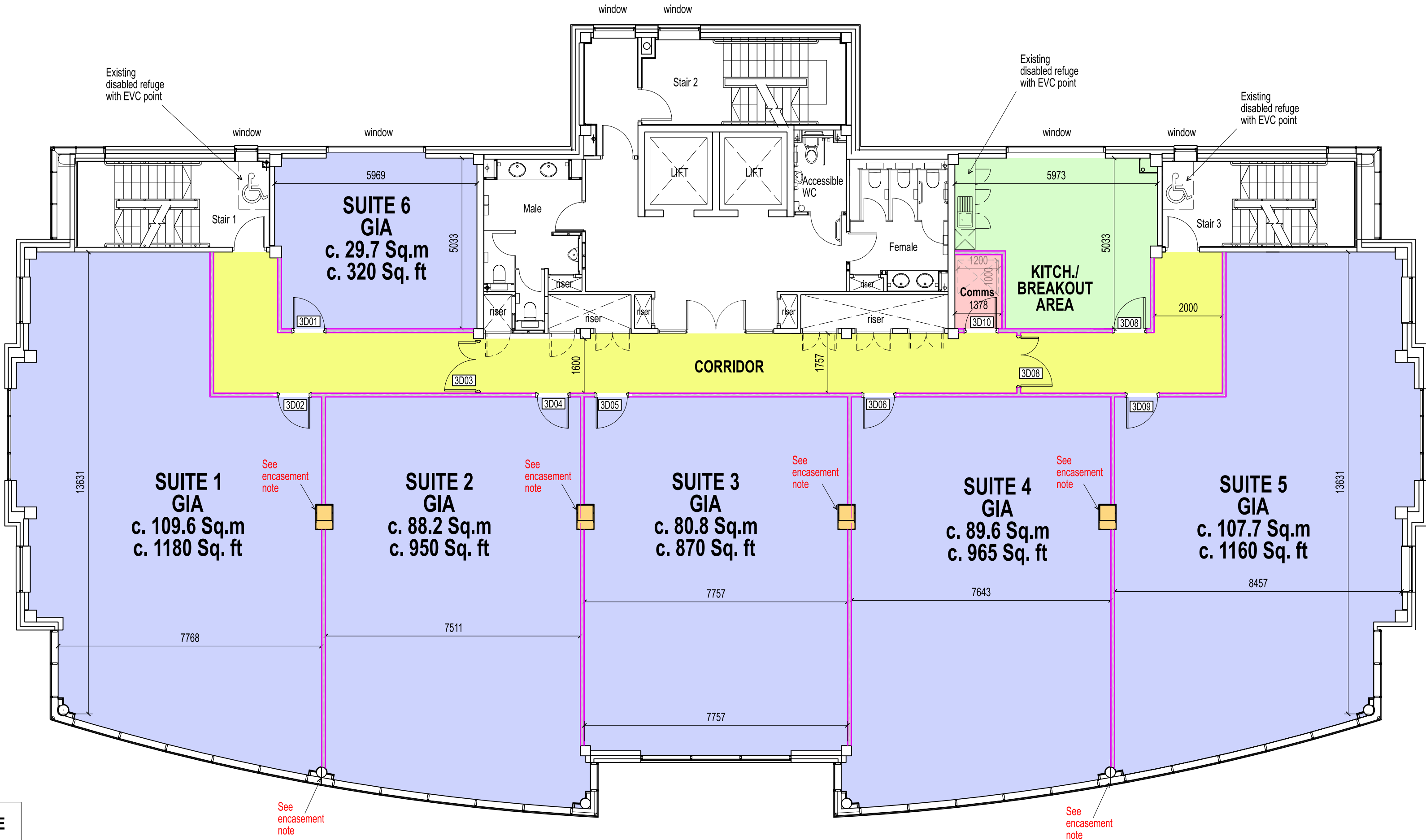

WALL SPECIFICATION NOTE

Unless otherwise noted; all new partitions to comprise:

2no. layers of 12.5mm of Gyproc WallBoard each side of Gypframe 70 S 50 °C Studs at 600mm centres.
25mm Isover Acoustic Partition Roll (APR 1200) in the cavity.
British Gypsum wall reference: A206047 (B) (EN)

Alternative partition systems by other manufacturers can be considered provided they achieve equal or better technical performance to the noted BG system.

BG specification suitable wall for heights up to 4800mm. Note max height of substrate above suspended ceilings to be reviewed on site; which may adjust partition specification to suit height.

Suitable fire rated head deflection detail to be included within wall specification that is compatible with system and appropriate for substrate. Allow for head detail that provides 50mm of downward deflection prior to confirmation of design deflection by a suitably qualified structural engineer.

For required fire rating of proposed partitions please refer to RGP fire strategy drawings.

Where new partition fixes to structural downstands within ceiling void; allow for any gaps between structure and floor above to be fully firestopped.

SCALE 1:100

